

DRAWING NUMBER: RG 482/A2/11

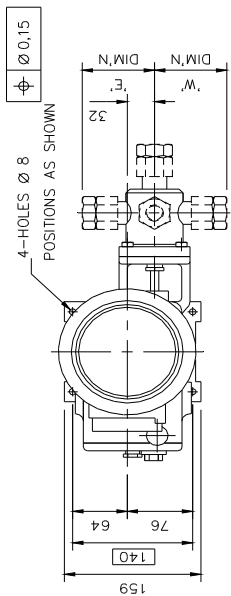

PG 16 TERMINAL PORT
 2 CABLE ENTRIES ON BOTH
 SIDES OF TERM. BOX

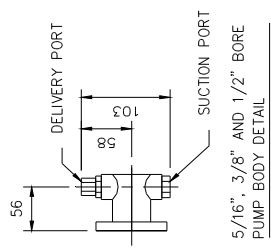
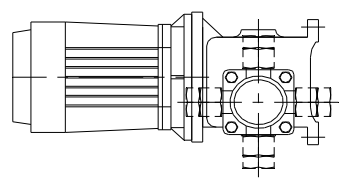
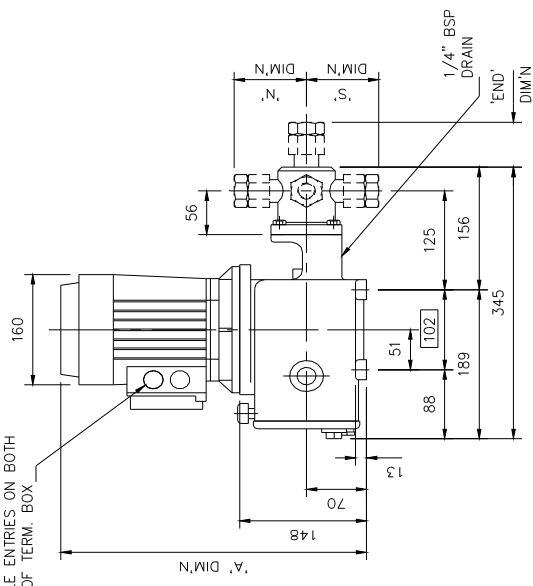

PUMP SIZE	BORE x STROKE	PORT SIZE BSP	'N' DIM/N	'S' DIM/N	'E' DIM/N	'W' DIM/N	'END' DIM/N
5/16" x 5/16"	5/16" x 1/2"						
3/8" x 5/16"	3/8" x 1/2"	1/4"	62	50	N/A	N/A	N/A
5/16" x 1"	3/8" x 1"						
1/2" x 1"	1/2" x 1"						
5/8" x 1"	3/4" x 1"	1/4"	80	80	80	80	47
3/4" x 1"	7/8" x 1"	3/8"	85	85	85	85	52
1" x 1"	1" x 1"						
1-1/8" x 1"	1-1/8" x 1"	1/2"	90	90	90	90	57
1-3/8" x 1"	1-3/8" x 1"						

MOTOR SIZE	ELECT. SUPPLY	'A' DIM/N			
		IP55	EExB		
180 W	240 VAC	D63	D71	D63	D71
	415 VAC	339	364	403	415
250 W	240 VAC				415
	415 VAC				429
370 W	240 VAC			364	415
	415 VAC			364	429

- PIPE CONNECTIONS
1. VALVES HAVE BSP FEMALE SCREWED CONNECTIONS AS ABOVE.
 2. 5/16" TO 1/2" BORE PUMPS CAN ONLY HAVE INLET AT BOTTOM (S) & OUTLET AT TOP (N).
 3. ALL OTHER PUMP SIZES CAN BE SPECIFIED N.S.E.W OR END WHEN VIEWED AT END OF PUMP.
 4. UNLESS OTHERWISE SPECIFIED, PUMPS WILL BE SUPPLIED INLET W & OUTLET E.
 5. PUMP BODY CAN BE ROTATED THROUGH 360° AFTER MANUFACTURE (EXCEPT SIZES UP TO AND INCL. 1/2" x 1").

ISSUE	DATE	ALTERATION	SIGN
11	9 DEC 94	REDRAWN ON A2 SHEET	CHU



MACHINE ALL OVER OR WHERE MARKED SURFACE FINISH UNLESS OTHERWISE SHOWN

DRAWN BY: CHU
 DATE: 9 DEC 94

FILE: \PYGME V0642
 DIMENSIONS IN mm
 ORIGINAL SCALE 1:4

REMOVE ALL BURRS AND SHARP EDGES. DO NOT SCALE EITHER WHOLLY OR PARTLY IF IN DOUBT ASK. PRINTS ARE RESIZING.

TITLE	PART NUMBER	DRAWING NUMBER
PYGME PLUNGER PUMP INSTALLATION DETAIL	1	RG 482/A2/11

